

C3250-10-IU

1T 5MP Infrared Zoom Fixed Dome Camera



Features

- Computing power 1 TOPS
- Support behavior analysis, exception detection, face and person
- 1/2.7" progressive scan CMOS
- High-quality images in super low illumination conditions and HD video surveillance for 24 hours a day
- Highlight Compensation (HLC), preventing key information loss in highlight conditions
- 120 dB super Wide Dynamic Range (WDR), ensuring that both foreground and background objects are clearly identified in environments with sharp light contrast
- Stream smoothing, meeting various requirements for video quality and fluency
- Traffic shaping, enabling precise control over instantaneous burst of video streams and delivering smooth video without packet loss
- TCP acceleration, enabling the network to carry video streams of higher quality
- Embedded video quality diagnosis functions
- AES-based stream encryption

Dimensions

Unit: mm

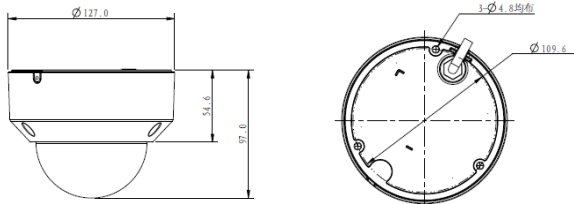

Recommended Accessories



Pendant mount
ACC3321



Wall mount
ACC3311

Technical Specifications

| Product Model | C3250-10-IU |
|-------------------------------|--|
| Intelligent Function | |
| CPU | Hi3516D |
| Computing Power | 1 TOPS |
| Behavior Analysis | Fast movement detection, tripwire crossing detection, intrusion detection, area entry/exit detection, and loitering detection |
| Exception detection | Audio existence detection, sudden volume increase or decrease detection, scene change detection, defocus detection and heat map (constraint scenario) |
| Face and person | Face capture, person detection |
| Camera | |
| Image Sensor | 1/2.7" 5-megapixel progressive scan CMOS |
| Memory | DDR3, 256MB*2 |
| Flash | SPI NAND FLASH 256MB |
| Effective Pixels | 2560(H)*1920(V) |
| Minimum Illumination | Color: 0.002 lux (F1.2, AGC ON, 1/30s shutter speed) B/W: 0.0005lux (F1.2, AGC ON, 1/30s shutter speed) 0 lux(Infra-red on) |
| Day/Night Mode | Auto (ICR), color, or B/W |
| WDR | 120 dB, physical WDR |
| White Balance | Auto tracking/Auto/Manual/OnePush |
| Backlight Compensation (BLC) | Supported (BLC area is selectable) |
| Highlight Compensation (HLC) | Supported |
| Image Defogging | Auto/Manual/Off |
| Digital Noise Reduction (DNR) | 2D/3D noise reduction |
| Lens and Illuminator | |
| Focal Length | 2.8-12mm |
| Maximum Aperture | F1.6-3.4 |
| Iris type | Fixed iris |
| Maximum Radiation Distance | 30 m |
| Function | |
| Video Encoding Format | H.265/H.264/MJPEG |
| Maximum Resolution | 2560×1920 |
| Angle of view | Horizontal: 30.6° (T)~94° (W); Vertical: 24° (T)~70° (W) |
| Frame Rate | Configurable (30 fps or 25 fps) |
| Multi-Channel Encoding | Triple streams |
| Intelligent Encoding | Extra265/264 |
| Voice Communication | Voice intercom and broadcast, channel-associated voice |
| Audio Encoding Format | G.711a/G.711u/G.726/OPUS |
| Camera Connection Protocol | GB/T 28181(2011,2016)、Huawei SDK、Huawei Rest API、GAT 1400、DB3311 |
| Network Protocol | TCP, UDP, IPv4, IPv6, DHCP, DHCPv6, DNS, ICMP, ICMPv6, IGMP, HTTPS, FTP, SFTP, RTP, RTSP, RTCP, SIP, ARP, SSL, NTP, SNMP(V1/V2/V3), 802.1x, QoS, DDNS, SMTP, PPPoE |
| Security Mode | User name and password authentication, 802.1X access authentication, and HTTPS digital certificate |
| Media Security | AES256-based SDK stream encryption |
| Video Digital Watermark | Fragile digital watermark (not supported in the MJPEG format) |
| Port | |
| Network Port | One RJ45 10M/100M adaptive Ethernet port |
| Communication Serial Port | One RS-485 port |
| Alarm Port | 2 alarm input port and 1 alarm output port |
| Audio Port | 1 audio input port (built-in microphone) and 1 audio output port |
| Storage Port | MicroSD card slot that supports microSDHC/microSDXC; maximum memory card capacity: 256 GB |
| General Specifications | |
| Power Supply | 12 V DC, PoE |
| Power Consumption | Maximum: 7 W; Typical: 5 W |
| Operating Temperature | -30° to +60 °C |
| Operating Humidity | 5% to 95% (non-condensing) |
| Surge Protection Rating | 4kV |
| Ingress Protection Rating | IP67 |
| Impact protection rating | IK10 |
| Weight | Net weight: 1 kg; Gross weight: 1.5 kg |
| Dimensions | Device: φ127×97 mm; Packing: 120×120×130mm |